

ABS Adaptor Fittings Inch Sizes Standard Range Tee 90°

Plain Socket x BSP Female Thread

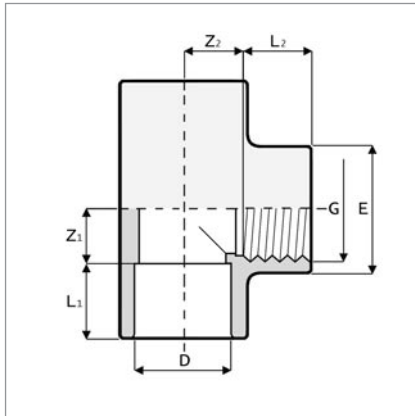

Size (D&G)	Code	L1	L2	Z1	Z2	E	Approx Wt. (grams)
1/2	3102-005	16.0	15.0	11.0	12.0	28.0	37.00
3/4	3102-007	19.0	16.0	14.0	16.0	34.0	42.00
1	3102-010	22.0	19.0	17.0	20.0	42.0	57.00
1 1/4	3102-012	26.0	21.0	21.0	25.0	51.0	95.00
1 1/2	3102-015	31.0	21.0	26.0	35.0	61.0	152.00
2	3102-020	38.0	25.0	33.0	45.0	75.0	289.00
2 1/2	3102-025	44.0	30.0	39.0	52.0	89.0	403.00
3	3102-030	51.0	33.0	47.0	64.0	106.0	642.00

Please note: This information is based on current manufacturers details, and is subject to change without notification.