

ABS Threaded Fittings Inch Sizes Standard Range Barrel Nipple

BSP Male Thread

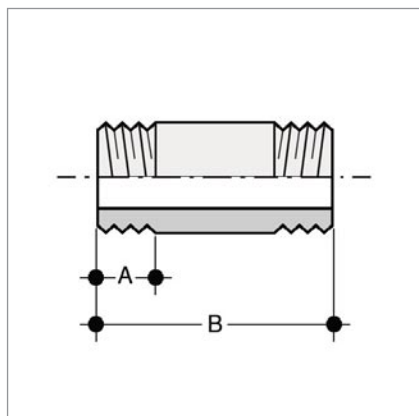

| Size (D&G) | Code | A | B | Approx Wt. (grams) |
|------------|------------|------|-------|--------------------|
| 3/8 | 3181-020BT | | | |
| 1/2 | 3182-020BT | 16.0 | 49.0 | 10.00 |
| 3/4 | 3183-020BT | 18.0 | 55.0 | 15.00 |
| 1 | 3184-030BT | 21.0 | 62.0 | 25.00 |
| 1 1/4 | 3185-035BT | 23.0 | 72.0 | 40.00 |
| 1 1/2 | 3186-035BT | 30.0 | 87.0 | 60.00 |
| 2 | 3187-040BT | 30.0 | 87.0 | 95.00 |
| 2 1/2 | 3188-050BT | 30.0 | 105.0 | 157.0 |
| 3 | 3189-050BT | 38.0 | 127.0 | 245.00 |
| 4 | 3190-060BT | 40.0 | 150.0 | 490.00 |

Please note: This information is based on current manufacturers details, and is subject to change without notification.