

Fittings with short Spigot

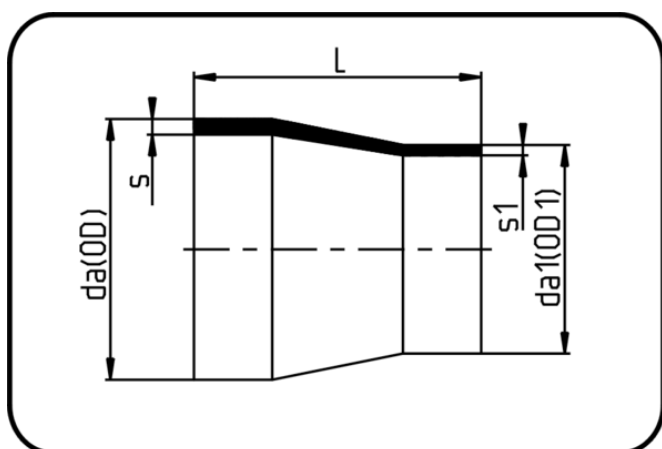

Code: 009

- Reducer concentric

- short spigot
- injection moulded

- Butt-welding

- PPR grey

Dimension	Code	Detail	da(OD) mm	da1(OD1) mm	s mm	L mm	s1 mm	Weight
75/63	11.009.7563.17	75/63 SDR17 ISO S-8	75	63	4,5	60	3,8	0.054
90/63	11.009.9063.17	90/63 SDR17 ISO S-8	90	63	5,4	66	3,8	0.08
90/75	11.009.9075.17	90/75 SDR17 ISO S-8	90	75	5,4	66	4,5	0.097
110/63	11.009.1163.17	110/63 SDR17 ISO S-8	110	63	6,6	90	3,8	0.15
110/75	11.009.1175.17	110/75 SDR17 ISO S-8	110	75	6,6	85	4,5	0.15
110/90	11.009.1190.17	110/90 SDR17 ISO S-8	110	90	6,6	85	5,4	0.159
125/63	11.009.1263.17	125/63 SDR17 ISO S-8	125	63	7,4	100	3,8	0.228
125/75	11.009.1275.17	125/75 SDR17 ISO S-8	125	75	7,4	100	4,5	0.218
125/90	11.009.1290.17	125/90 SDR17 ISO S-8	125	90	7,4	90	5,4	0.186
125/110	11.009.1211.17	125/110 SDR17 ISO S-8	125	110	7,4	90	6,6	0.243
140/75	11.009.1475.17	140/75 SDR17 ISO S-8	140	75	8,3	110	4,5	0.331
140/90	11.009.1490.17	140/90 SDR17 ISO S-8	140	90	8,3	110	5,4	0.29
140/110	11.009.1411.17	140/110 SDR17 ISO S-8	140	110	8,3	100	6,6	0.28
140/125	11.009.1412.17	140/125 SDR17 ISO S-8	140	125	8,3	100	7,4	0.317
160/90	11.009.1690.17	160/90 SDR17 ISO S-8	160	90	9,5	115	5,4	0.42
160/110	11.009.1611.17	160/110 SDR17 ISO S-8	160	110	9,5	115	6,6	0.41
160/125	11.009.1612.17	160/125 SDR17 ISO S-8	160	125	9,5	110	7,4	0.45
160/140	11.009.1614.17	160/140 SDR17 ISO S-8	160	140	9,5	110	8,3	0.45
180/90	11.009.1890.17	180/90 SDR17 ISO S-8	180	90	10,7	157	5,4	0.746
180/110	11.009.1811.17	180/110 SDR17 ISO S-8	180	110	10,7	157	6,6	0.743
180/125	11.009.1812.17	180/125 SDR17 ISO S-8	180	125	10,7	122	7,4	0.56
180/140	11.009.1814.17	180/140 SDR17 ISO S-8	180	140	10,7	136	8,3	0.68
180/160	11.009.1816.17	180/160 SDR17 ISO S-8	180	160	10,7	122	9,5	0.65

Dimension	Code	Detail	da(OD) mm	da1(OD1) mm	s mm	L mm	s1 mm	Weight
200/140	11.009.2014.17	200/140 SDR17 ISO S-8	200	140	11,9	137	8,3	0.86
200/160	11.009.2016.17	200/160 SDR17 ISO S-8	200	160	11,9	132	9,5	0.84
200/180	11.009.2018.17	200/180 SDR17 ISO S-8	200	180	11,9	137	10,7	0.9
225/140	11.009.2214.17	225/140 SDR17 ISO S-8	225	140	13,4	162	8,3	1.21
225/160	11.009.2216.17	225/160 SDR17 ISO S-8	225	160	13,4	140	9,5	0.985
225/180	11.009.2218.17	225/180 SDR17 ISO S-8	225	180	13,4	162	10,7	1.328
225/200	11.009.2220.17	225/200 SDR17 ISO S-8	225	200	13,4	162	11,9	1.31
250/160	11.009.2516.17	250/160 SDR17 ISO S-8	250	160	14,8	149	9,5	1.46
250/180	11.009.2518.17	250/180 SDR17 ISO S-8	250	180	14,8	177	10,7	1.66
250/200	11.009.2521.17	250/200 SDR17 ISO S-8	250	200	14,8	144	11,9	1.38
250/225	11.009.2522.17	250/225 SDR17 ISO S-8	250	225	14,8	144	13,4	1.48
280/200	11.009.2820.17	280/200 SDR17 ISO S-8	280	200	16,6	202	11,9	2.34
280/225	11.009.2822.17	280/225 SDR17 ISO S-8	280	225	16,6	202	13,4	2.45
280/250	11.009.2825.17	280/250 SDR17 ISO S-8	280	250	16,6	165	14,8	2.16
315/200	11.009.3120.17	315/200 SDR17 ISO S-8	315	200	18,7	196	11,9	3
315/225	11.009.3122.17	315/225 SDR17 ISO S-8	315	225	18,7	200	13,4	3.12
315/250	11.009.3125.17	315/250 SDR17 ISO S-8	315	250	18,7	200	14,8	3.07
315/280	11.009.3128.17	315/280 SDR17 ISO S-8	315	280	18,7	198	16,6	3.2
25/20	11.009.2520.11	25/20 SDR11 ISO S-5	25	20	2,3	38	1,9	0.005
32/20	11.009.3220.11	32/20 SDR11 ISO S-5	32	20	2,9	40	1,9	0.008
32/25	11.009.3225.11	32/25 SDR11 ISO S-5	32	25	2,9	40	2,3	0.009
40/20	11.009.4020.11	40/20 SDR11 ISO S-5	40	20	3,7	43	1,9	0.014
40/25	11.009.4025.11	40/25 SDR11 ISO S-5	40	25	3,7	43	2,3	0.014
40/32	11.009.4032.11	40/32 SDR11 ISO S-5	40	32	3,7	37	2,9	0.013
50/25	11.009.5025.11	50/25 SDR11 ISO S-5	50	25	4,6	47	2,3	0.02
50/32	11.009.5032.11	50/32 SDR11 ISO S-5	50	32	4,6	41	2,9	0.02
50/40	11.009.5040.11	50/40 SDR11 ISO S-5	50	40	4,6	42	3,7	0.022
63/32	11.009.6332.11	63/32 SDR11 ISO S-5	63	32	5,8	57	2,9	0.04
63/40	11.009.6340.11	63/40 SDR11 ISO S-5	63	40	5,8	51	3,7	0.04
63/50	11.009.6350.11	63/50 SDR11 ISO S-5	63	50	5,8	52	4,6	0.044
75/32	11.009.7532.11	75/32 SDR11 ISO S-5	75	32	6,8	70	2,9	0.065
75/40	11.009.7540.11	75/40 SDR11 ISO S-5	75	40	6,8	70	3,7	0.067
75/50	11.009.7550.11	75/50 SDR11 ISO S-5	75	50	6,8	59	4,6	0.066
75/63	11.009.7563.11	75/63 SDR11 ISO S-5	75	63	6,8	60	5,8	0.071
90/50	11.009.9050.11	90/50 SDR11 ISO S-5	90	50	8,2	76	4,6	0.11
90/63	11.009.9063.11	90/63 SDR11 ISO S-5	90	63	8,2	66	5,8	0.108
90/75	11.009.9075.11	90/75 SDR11 ISO S-5	90	75	8,2	66	6,8	0.12
110/50	11.009.1150.11	110/50 SDR11 ISO S-5	110	50	10	90	4,6	0.186
110/63	11.009.1163.11	110/63 SDR11 ISO S-5	110	63	10	90	5,8	0.197

Dimension	Code	Detail	da(OD) mm	da1(OD1) mm	s mm	L mm	s1 mm	Weight
110/75	11.009.1175.11	110/75 SDR11 ISO S-5	110	75	10	85	6,8	0.21
110/90	11.009.1190.11	110/90 SDR11 ISO S-5	110	90	10	85	8,2	0.225
125/63	11.009.1263.11	125/63 SDR11 ISO S-5	125	63	11,4	100	5,8	0.275
125/75	11.009.1275.11	125/75 SDR11 ISO S-5	125	75	11,4	100	6,8	0.291
125/90	11.009.1290.11	125/90 SDR11 ISO S-5	125	90	11,4	90	8,2	0.282
125/110	11.009.1211.11	125/110 SDR11 ISO S-5	125	110	11,4	90	10	0.32
140/75	11.009.1475.11	140/75 SDR11 ISO S-5	140	75	12,7	110	6,8	0.383
140/90	11.009.1490.11	140/90 SDR11 ISO S-5	140	90	12,7	110	8,2	0.404
140/110	11.009.1411.11	140/110 SDR11 ISO S-5	140	110	12,7	100	10	0.409
140/125	11.009.1412.11	140/125 SDR11 ISO S-5	140	125	12,7	100	11,4	0.44
160/90	11.009.1690.11	160/90 SDR11 ISO S-5	160	90	14,6	115	8,2	0.55
160/110	11.009.1611.11	160/110 SDR11 ISO S-5	160	110	14,6	115	10	0.585
160/125	11.009.1612.11	160/125 SDR11 ISO S-5	160	125	14,6	110	11,4	0.59
160/140	11.009.1614.11	160/140 SDR11 ISO S-5	160	140	14,6	110	12,7	0.62
180/90	11.009.1890.11	180/90 SDR11 ISO S-5	180	90	16,4	157	8,2	0.94
180/110	11.009.1811.11	180/110 SDR11 ISO S-5	180	110	16,4	157	10	1.01
180/125	11.009.1812.11	180/125 SDR11 ISO S-5	180	125	16,4	122	11,4	0.82
180/140	11.009.1814.11	180/140 SDR11 ISO S-5	180	140	16,4	136	12,8	1.01
180/160	11.009.1816.11	180/160 SDR11 ISO S-5	180	160	16,4	122	14,6	0.905
200/140	11.009.2014.11	200/140 SDR11 ISO S-5	200	140	18,2	137	12,7	1.14
200/160	11.009.2016.11	200/160 SDR11 ISO S-5	200	160	18,2	132	14,6	1.166
200/180	11.009.2018.11	200/180 SDR11 ISO S-5	200	180	18,2	137	16,4	1.31
225/140	11.009.2214.11	225/140 SDR11 ISO S-5	225	140	20,5	162	12,8	1.68
225/160	11.009.2216.11	225/160 SDR11 ISO S-5	225	160	20,5	136	14,6	1.42
225/180	11.009.2218.11	225/180 SDR11 ISO S-5	225	180	20,5	162	16,4	1.8
225/200	11.009.2220.11	225/200 SDR11 ISO S-5	225	200	20,5	162	18,2	1.92
250/160	11.009.2516.11	250/160 SDR11 ISO S-5	250	160	22,7	160	14,6	1.895
250/180	11.009.2518.11	250/180 SDR11 ISO S-5	250	180	22,7	162	16,4	1.98
250/200	11.009.2521.11	250/200 SDR11 ISO S-5	250	200	22,7	144	18,2	2
250/225	11.009.2522.11	250/225 SDR11 ISO S-5	250	225	22,7	144	20,5	2.08
280/200	11.009.2820.11	280/200 SDR11 ISO S-5	280	200	25,4	188	18,2	2.99
280/225	11.009.2822.11	280/225 SDR11 ISO S-5	280	225	25,4	192	20,5	3.18
280/250	11.009.2825.11	280/250 SDR11 ISO S-5	280	250	25,4	165	22,7	3.02
315/200	11.009.3120.11	315/200 SDR11 ISO S-5	315	200	28,6	200	18,2	3.86
315/225	11.009.3122.11	315/225 SDR11 ISO S-5	315	225	28,6	207	20,5	4
315/250	11.009.3125.11	315/250 SDR11 ISO S-5	315	250	28,6	200	22,7	4.08
315/280	11.009.3128.11	315/280 SDR11 ISO S-5	315	280	28,6	198	25,4	4.44