

## Electro Fusion Fittings

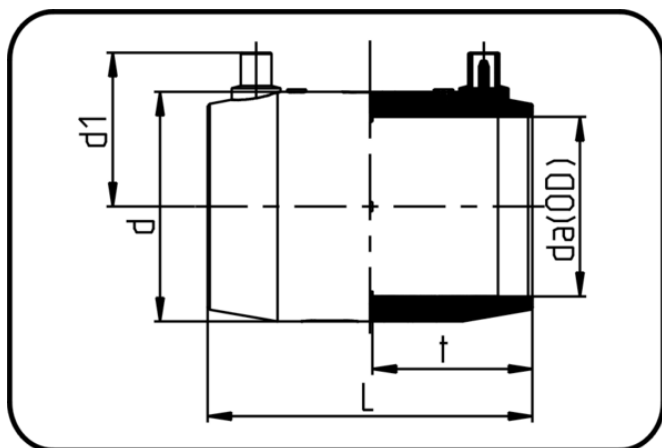

Code: 173

- E-Coupler
- MOP water 25bar/gas 10bar
- MOP water ÖVGW 16bar
- injection moulded
- Electro-fusion
- PE 100-RC black

Dimension	Code	Detail	da(OD) mm	L mm	d mm	d1 mm	t mm	Weight
20	70.173.0020.11	20 SDR 11-7,4	20	73,5	30	37	36	0.035
25	70.173.0025.11	25 SDR 11-7,4	25	79,5	35	39	39,5	0.044
32	70.173.0032.11	32 SDR 11-7,4	32	86,5	42	43	43	0.06
40	70.173.0040.11	40 SDR 17-7,4	40	97,5	53	47	48	0.084
50	70.173.0050.11	50 SDR 17-7,4	50	108,5	66,5	53	54	0.15
63	70.173.0063.11	63 SDR 17-7,4	63	124,5	83	59	62	0.26
75	70.173.0075.11	75 SDR 17-7,4	75	139,5	97	65,5	68,5	0.37
90	70.173.0090.11	90 SDR 17-7,4	90	138,5	112	72	68	0.44
110	70.173.0110.11	110 SDR 17-7,4	110	149	136	83	73	0.69
125	70.173.0125.11	125 SDR 17-7,4	125	169,5	155	91	83,5	0.986
140	70.173.0140.11	140 SDR 17-7,4	140	179	180	99	89,5	1.37
160	70.173.0160.11	160 SDR 17-7,4	160	180	197	109	88	1.76
180	70.173.0180.11	180 SDR 26-7,4	180	199,5	221	119	97,5	2.46
200	70.173.0200.11	200 SDR 26-7,4	200	215,5	245	127	105	3.14
225	70.173.0225.11	225 SDR 26-7,4	225	229	275	142	112	4.219
250	70.173.0250.11	250 SDR 26-7,4	250	238	310	155	116,5	5.26
280	70.173.0280.11	280 SDR 26-7,4	280	249	346	180	121,5	7.7
315	70.173.0315.11	315 SDR 26-7,4	315	260	386	187	127,5	7.891

## Electro Fusion Fittings

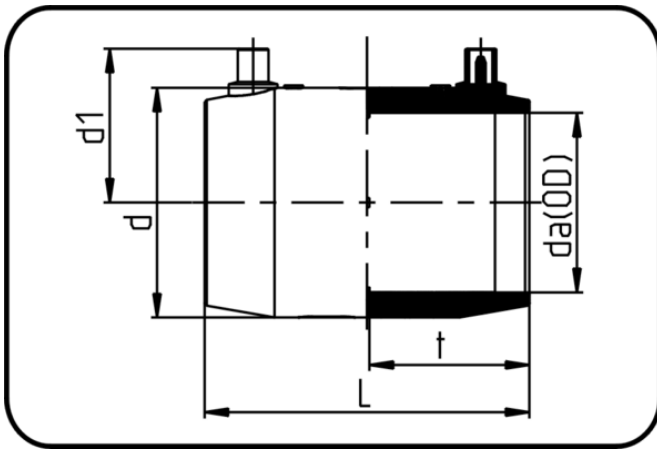

Code: 173

- E-Coupler
- MOP water 16bar/gas 10bar
- injection moulded
- Electro-fusion
- PE 100-RC black

Dimension	Code	Detail	da(OD) mm	L mm	d mm	d1 mm	t mm	Weight
355	70.173.0355.11	355 SDR 26-11	355	280	445	225	136,5	14.75
400	70.173.0400.11	400 SDR 26-11	400	300	499	254	146,5	15.9
450	70.173.0450.11	450 SDR 17-11	450	338	552	260	166	20.6
500	70.173.0500.11	500 SDR 17-11	500	358	604	289	178,5	25.169