

Electro Fusion Fittings

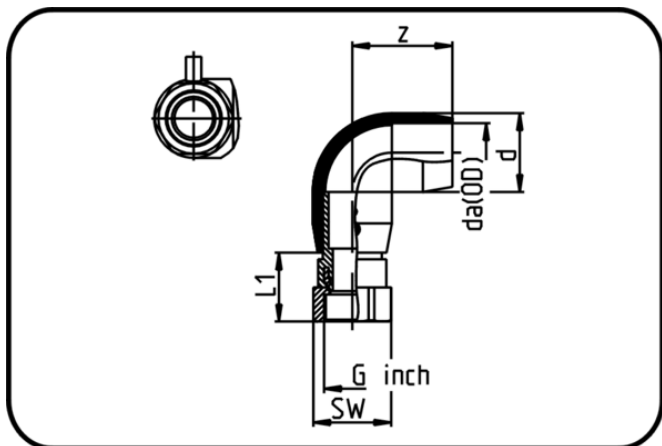

- E-Adaptor Elbow 90°
- with steel-female thread
- injection moulded
- Electro-fusion
- PE 100 black

Dimension	Code	Detail	da(OD) mm	z mm	L1 mm	d mm	SW mm	G inch	Weight
20 X 1/2	25.187.2021.11	20X1/2" SDR 11	20	58	36	30	32	0,5	0.17
25 X 3/4	25.187.2526.11	25X3/4" SDR 11	25	61	40	35	36	0,75	0.2
32 X 1	25.187.3233.11	32X1" SDR 11	32	65	44	42	41	1	0.262
40 X 1 1/4	25.187.4041.11	40X1 1/4" SDR 17/11	40	75	49	53	50	1,25	0.41
50 X 1 1/2	25.187.5051.11	50X1 1/2" SDR 17/11	50	85	56	67	60	1,5	0.74
63 X 2	25.187.6364.11	63X2" SDR 17/11	63	100	67	83	70	2	1.12