

Fittings

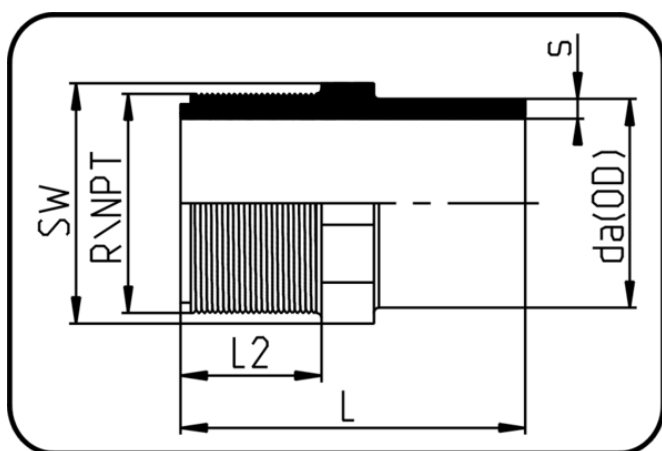

Code: 033.1

- **Adaptor Male Thread**
- NPT-thread
- injection moulded
- **Butt + IR + HPF-welding**
- **PVDF natural**

Dimension	Code	Detail	da(OD) mm	s mm	L mm	L2 mm	SW mm	NPT inch	Weight
20	30.033.2021.21	20X1/2" SDR21 MOP 10 bar	20	1,9	46	18	22	0,5	0.013
25	30.033.2526.21	25X3/4" SDR21 MOP 10 bar	25	1,9	51	20	27	0,75	0.023
32	30.033.3233.21	32X1" SDR21 MOP 10 bar	32	2,4	61	23	36	1	0.04
40	30.033.4041.21	40X1 1/4" SDR21 MOP 10 bar	40	2,4	66	27	46	1,25	0.065
50	30.033.5051.21	50X1 1/2" SDR21 MOP 10 bar	50	3	74	29	55	1,5	0.098
63	30.033.6364.21	63X2" SDR21 MOP 10 bar	63	3	80	31	65	2	0.143