

Fittings

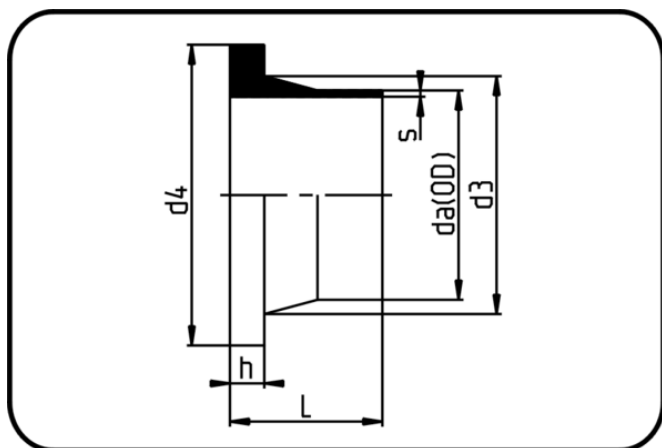

Code: 012

- Stub Flange DIN
- short spigot
- injection moulded
- Butt + IR + HPF-welding
- PVDF natural

Backing Rings please see Accessories.

| Dimension | Code | Detail | da(OD) mm | s mm | L mm | d3 mm | d4 mm | h mm | Weight |
|-----------|----------------|------------------------|--------------|---------|---------|----------|----------|---------|--------|
| 90 | 30.012.0090.33 | 90X2,8 SDR33 ISO S-16 | 90 | 2,8 | 80 | 105 | 138 | 11 | 0.355 |
| 110 | 30.012.0110.33 | 110X3,4 SDR33 ISO S-16 | 110 | 3,4 | 80 | 125 | 158 | 12 | 0.457 |
| 125 | 30.012.0125.33 | 125X3,9 SDR33 ISO S-16 | 125 | 3,9 | 80 | 132 | 158 | 14 | 0.459 |
| 140 | 30.012.0140.33 | 140X4,3 SDR33 ISO S-16 | 140 | 4,3 | 80 | 155 | 188 | 15 | 0.663 |
| 160 | 30.012.0160.33 | 160X4,9 SDR33 ISO S-16 | 160 | 4,9 | 81 | 175 | 212 | 16 | 0.937 |
| 180 | 30.012.0180.33 | 180X5,5 SDR33 ISO S-16 | 180 | 5,5 | 80 | 183 | 212 | 18 | 0.795 |
| 200 | 30.012.0200.33 | 200X6,2 SDR33 ISO S-16 | 200 | 6,2 | 100 | 232 | 268 | 18 | 1.87 |
| 225 | 30.012.0225.33 | 225X6,9 SDR33 ISO S-16 | 225 | 6,9 | 100 | 235 | 268 | 18 | 1.45 |
| 250 | 30.012.0250.33 | 250X7,7 SDR33 ISO S-16 | 250 | 7,7 | 100 | 285 | 320 | 20 | 2.74 |
| 280 | 30.012.0280.33 | 280X8,6 SDR33 ISO S-16 | 280 | 8,6 | 100 | 288 | 320 | 20 | 2.109 |
| 315 | 30.012.0315.33 | 315X9,7 SDR33 ISO S-16 | 315 | 9,7 | 100 | 335 | 370 | 20 | 3.16 |
| 20 | 30.012.0020.21 | 20X1,9 SDR21 ISO S-10 | 20 | 1,9 | 49 | 27 | 45 | 6 | 0.029 |
| 25 | 30.012.0025.21 | 25X1,9 SDR21 ISO S-10 | 25 | 1,9 | 50 | 33 | 58 | 6,5 | 0.044 |
| 32 | 30.012.0032.21 | 32X2,4 SDR21 ISO S-10 | 32 | 2,4 | 50 | 40 | 68 | 7 | 0.066 |
| 40 | 30.012.0040.21 | 40X2,4 SDR21 ISO S-10 | 40 | 2,4 | 50 | 50 | 78 | 8 | 0.093 |
| 50 | 30.012.0050.21 | 50X3,0 SDR21 ISO S-10 | 50 | 3 | 50 | 61 | 88 | 9 | 0.126 |
| 63 | 30.012.0063.21 | 63X3,0 SDR21 ISO S-10 | 63 | 3 | 50 | 76 | 102 | 10 | 0.176 |
| 75 | 30.012.0075.21 | 75X3,6 SDR21 ISO S-10 | 75 | 3,6 | 50 | 89 | 122 | 10 | 0.238 |
| 90 | 30.012.0090.21 | 90X4,3 SDR21 ISO S-10 | 90 | 4,3 | 80 | 105 | 138 | 11 | 0.407 |
| 110 | 30.012.0110.21 | 110X5,3 SDR21 ISO S-10 | 110 | 5,3 | 80 | 125 | 158 | 12 | 0.537 |
| 125 | 30.012.0125.21 | 125X6,0 SDR21 ISO S-10 | 125 | 6 | 80 | 132 | 158 | 14 | 0.612 |
| 140 | 30.012.0140.21 | 140X6,7 SDR21 ISO S-10 | 140 | 6,7 | 80 | 155 | 188 | 15 | 0.81 |

| Dimension | Code | Detail | da(OD) mm | s mm | L mm | d3 mm | d4 mm | h mm | Weight |
|-----------|----------------|-------------------------|--------------|---------|---------|----------|----------|---------|--------|
| 160 | 30.012.0160.21 | 160X7,7 SDR21 ISO S-10 | 160 | 7,7 | 81 | 175 | 212 | 16 | 1.071 |
| 180 | 30.012.0180.21 | 180X8,6 SDR21 ISO S-10 | 180 | 8,6 | 80 | 183 | 212 | 18 | 1.04 |
| 200 | 30.012.0200.21 | 200X9,6 SDR21 ISO S-10 | 200 | 9,6 | 98 | 232 | 268 | 20 | 2.26 |
| 225 | 30.012.0225.21 | 225X10,8 SDR21 ISO S-10 | 225 | 10,8 | 100 | 235 | 268 | 20 | 1.964 |
| 250 | 30.012.0250.21 | 250X11,9 SDR21 ISO S-10 | 250 | 11,9 | 100 | 285 | 320 | 22 | 3.33 |
| 280 | 30.012.0280.21 | 280X13,4 SDR21 ISO S-10 | 280 | 13,4 | 100 | 288 | 320 | 25 | 2.791 |