

## Valves

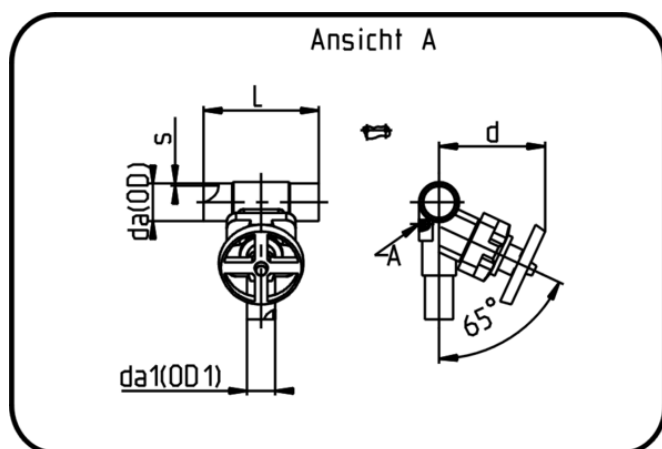

Code: 343

- T-Diaphragm Valve
- manually controlled
- EPDM/PTFE diaphragm
- Butt + IR + HPF-welding
- PVDF UHP natural

| Dimension | Code           | Detail                   | da(OD)<br>mm | da1(OD1)<br>mm | s<br>mm | L<br>mm | d<br>mm | Weight |
|-----------|----------------|--------------------------|--------------|----------------|---------|---------|---------|--------|
| 20/20     | 35.343.2020.21 | 20/20 - SDR21 MOP 10 bar | 20           | 20             | 1,9     | 164     | 118     | 0.611  |
| 25/20     | 35.343.2520.21 | 25/20 - SDR21 MOP 10 bar | 25           | 20             | 1,9     | 164     | 118     | 0.6    |
| 25/25     | 35.343.2525.21 | 25/25 - SDR21 MOP 10 bar | 25           | 25             | 1,9     | 164     | 118     | 0.598  |
| 32/20     | 35.343.3220.21 | 32/20 - SDR21 MOP 10 bar | 32           | 20             | 2,4     | 164     | 128     | 0.88   |
| 32/25     | 35.343.3225.21 | 32/25 - SDR21 MOP 10 bar | 32           | 25             | 2,4     | 164     | 128     | 0.88   |
| 32/32     | 35.343.3232.21 | 32/32 - SDR21 MOP 10 bar | 32           | 32             | 2,4     | 164     | 128     | 0.891  |
| 40/20     | 35.343.4020.21 | 40/20 - SDR21 MOP 10 bar | 40           | 20             | 2,4     | 184     | 128     | 0.913  |
| 40/25     | 35.343.4025.21 | 40/25 - SDR21 MOP 10 bar | 40           | 25             | 2,4     | 184     | 128     | 0.916  |
| 40/32     | 35.343.4032.21 | 40/32 - SDR21 MOP 10 bar | 40           | 32             | 2,4     | 184     | 128     | 0.934  |
| 40/40     | 35.343.4040.21 | 40/40 - SDR21 MOP 10 bar | 40           | 40             | 2,4     | 237     | 189     | 2.638  |
| 50/20     | 35.343.5020.21 | 50/20 - SDR21 MOP 10 bar | 50           | 20             | 3       | 184     | 128     | 0.978  |
| 50/25     | 35.343.5025.21 | 50/25 - SDR21 MOP 10 bar | 50           | 25             | 3       | 184     | 128     | 0.994  |
| 50/32     | 35.343.5032.21 | 50/32 - SDR21 MOP 10 bar | 50           | 32             | 3       | 184     | 128     | 0.999  |
| 50/40     | 35.343.5040.21 | 50/40 - SDR21 MOP 10 bar | 50           | 40             | 3       | 237     | 200     | 3.01   |
| 50/50     | 35.343.5050.21 | 50/50 - SDR21 MOP 10 bar | 50           | 50             | 3       | 235     | 200     | 3.02   |
| 63/20     | 35.343.6320.21 | 63/20 - SDR21 MOP 10 bar | 63           | 20             | 3       | 184     | 128     | 1.04   |
| 63/25     | 35.343.6325.21 | 63/25 - SDR21 MOP 10 bar | 63           | 25             | 3       | 184     | 128     | 1.058  |
| 63/32     | 35.343.6332.21 | 63/32 - SDR21 MOP 10 bar | 63           | 32             | 3       | 184     | 128     | 1.085  |
| 63/40     | 35.343.6340.21 | 63/40 - SDR21 MOP 10 bar | 63           | 40             | 3       | 235     | 199     | 3.102  |
| 63/50     | 35.343.6350.21 | 63/50 - SDR21 MOP 10 bar | 63           | 50             | 3       | 235     | 199     | 3.12   |
| 63/63     | 35.343.6363.21 | 63/63 - SDR21 MOP 10 bar | 63           | 63             | 3       | 235     | 199     | 3.175  |
| 75/25     | 35.343.7525.21 | 75/25 - SDR21 MOP 10 bar | 75           | 25             | 3,6     | 210     | 133     | 1.232  |
| 75/32     | 35.343.7532.21 | 75/32 - SDR21 MOP 10 bar | 75           | 32             | 3,6     | 210     | 133     | 1.26   |
|           |                |                          |              |                |         |         |         |        |

| Dimension | Code           | Detail                       | da(OD)<br>mm | da1(OD1)<br>mm | s<br>mm | L<br>mm | d<br>mm | Weight |
|-----------|----------------|------------------------------|--------------|----------------|---------|---------|---------|--------|
| 75/40     | 35.343.7540.21 | 75/40 - SDR21 MOP 10 bar     | 75           | 40             | 3,6     | 210     | 199     | 3.26   |
| 75/50     | 35.343.7550.21 | 75/50 - SDR21 MOP 10 bar     | 75           | 50             | 3,6     | 210     | 199     | 3.198  |
| 75/63     | 35.343.7563.21 | 75/63 - SDR21 MOP 10 bar     | 75           | 63             | 3,6     | 210     | 199     | 3.195  |
| 90/20     | 35.343.9020.21 | 90/20 - SDR21 MOP 10 bar     | 90           | 20             | 4,3     | 210     | 135     | 0.92   |
| 90/25     | 35.343.9025.21 | 90/25 - SDR21 MOP 10 bar     | 90           | 25             | 4,3     | 210     | 135     | 1.49   |
| 90/32     | 35.343.9032.21 | 90/32 - SDR21 MOP 10 bar     | 90           | 32             | 4,3     | 210     | 135     | 1.411  |
| 90/40     | 35.343.9040.21 | 90/40 - SDR21 MOP 10 bar     | 90           | 40             | 4,3     | 210     | 199     | 3.325  |
| 90/50     | 35.343.9050.21 | 90/50 - SDR21 MOP 10 bar     | 90           | 50             | 4,3     | 210     | 199     | 3.42   |
| 90/63     | 35.343.9063.21 | 90/63 - SDR21 MOP 10 bar     | 90           | 63             | 4,3     | 210     | 199     | 3.357  |
| 110/20    | 35.343.1120.21 | 110/20 - SDR21 MOP 10 bar    | 110          | 20             | 5,3     | 210     | 140     | 1.79   |
| 110/25    | 35.343.1125.21 | 110/25 - SDR21 MOP 10 bar    | 110          | 25             | 5,3     | 210     | 140     | 1.74   |
| 110/32    | 35.343.1132.21 | 110/32 - SDR21 MOP 10 bar    | 110          | 32             | 5,3     | 210     | 140     | 1.748  |
| 110/40    | 35.343.1140.21 | 110/40 - SDR21 MOP 10 bar    | 110          | 40             | 5,3     | 210     | 199     | 3.734  |
| 110/50    | 35.343.1150.21 | 110/50 - SDR21 MOP 10 bar    | 110          | 50             | 5,3     | 210     | 199     | 3.728  |
| 110/63    | 35.343.1163.21 | 110/63 - SDR21 MOP 10 bar    | 110          | 63             | 5,3     | 210     | 199     | 3.77   |
| 140/32    | 35.343.1432.21 | 140/32 - SDR21 MOP 10 bar    | 140          | 32             | 6,7     | 210     | 144     | 2.28   |
| 140/40    | 35.343.1440.21 | 140/40 - SDR21 MOP 10 bar    | 140          | 40             | 6,7     | 250     | 205     | 4.61   |
| 140/50    | 35.343.1450.21 | 140/50 - SDR21 MOP 10 bar    | 140          | 50             | 6,7     | 250     | 205     | 4.3    |
| 140/63    | 35.343.1463.21 | 140/63 - SDR21 MOP 10 bar    | 140          | 63             | 6,7     | 250     | 205     | 4.595  |
| 160/32    | 35.343.1632.21 | 160/32 - SDR21 MOP 10 bar    | 160          | 32             | 7,7     | 212     | 144     | 2.63   |
| 160/40    | 35.343.1640.21 | 160/40 - SDR21 MOP 10 bar    | 160          | 40             | 7,7     | 250     | 205     | 4.8    |
| 160/50    | 35.343.1650.21 | 160/50 - SDR21 MOP 10 bar    | 160          | 50             | 7,7     | 250     | 205     | 4.915  |
| 160/63    | 35.343.1663.21 | 160/63 - SDR21 MOP 10 bar    | 160          | 63             | 7,7     | 250     | 205     | 4.97   |
| 90/20     | 35.343.9020.31 | 90/20 - SDR33/21 MOP 10 bar  | 90           | 20             | 2,8     | 210     | 135     | 1.33   |
| 90/25     | 35.343.9025.31 | 90/25 - SDR33/21 MOP 10 bar  | 90           | 25             | 2,8     | 210     | 135     | 1.33   |
| 90/32     | 35.343.9032.31 | 90/32 - SDR33/21 MOP 10 bar  | 90           | 32             | 2,8     | 210     | 135     | 1.327  |
| 90/40     | 35.343.9040.31 | 90/40 - SDR33/21 MOP 10 bar  | 90           | 40             | 2,8     | 210     | 199     | 3.27   |
| 90/50     | 35.343.9050.31 | 90/50 - SDR33/21 MOP 10 bar  | 90           | 50             | 2,8     | 210     | 199     | 3.38   |
| 90/63     | 35.343.9063.31 | 90/63 - SDR33/21 MOP 10 bar  | 90           | 63             | 2,8     | 210     | 199     | 3.24   |
| 110/20    | 35.343.1120.31 | 110/20 - SDR33/21 MOP 10 bar | 110          | 20             | 3,4     | 210     | 140     | 1.67   |
| 110/25    | 35.343.1125.31 | 110/25 - SDR33/21 MOP 10 bar | 110          | 25             | 3,4     | 210     | 140     | 1.62   |
| 110/32    | 35.343.1132.31 | 110/32 - SDR33/21 MOP 10 bar | 110          | 32             | 3,4     | 210     | 140     | 1.62   |
| 110/40    | 35.343.1140.31 | 110/40 - SDR33/21 MOP 10 bar | 110          | 40             | 3,4     | 210     | 199     | 3.64   |
| 110/50    | 35.343.1150.31 | 110/50 - SDR33/21 MOP 10 bar | 110          | 50             | 3,4     | 210     | 199     | 3.65   |
| 110/63    | 35.343.1163.31 | 110/63 - SDR33/21 MOP 10 bar | 110          | 63             | 3,4     | 210     | 199     | 3.71   |