

## Valves

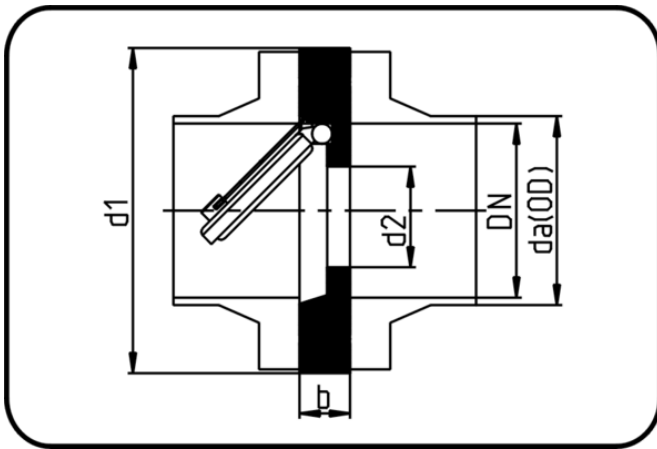

Code: 339.1

- **Swing Type Check Valve+Spring**
- Spring V4A / FPM-Sealing S4
- injection moulded
- **Flange connection DIN**
- **PVDF UHP natural**

Dimension	Code	Detail	da(OD) mm	d1 mm	d2 mm	b mm	DN mm	Weight
40	35.339.1040.33	40 - MOP 8 bar	40	85	17,8	15,5	32	0.155
50	35.339.1050.33	50 - MOP 8 bar	50	95	22	16	40	0.197
63	35.339.1063.33	63 - MOP 8 bar	63	108,5	31,8	20,5	50	0.299
125	35.339.1125.33	125 - MOP 8 bar	125	162,6	69,5	22	100	0.77
140	35.339.1140.33	140 - MOP 8 bar	140	192,5	89,7	22,5	125	0.9
180	35.339.1180.33	180 - MOP 8 bar	180	219	108,4	26	150	1.42