

Valves

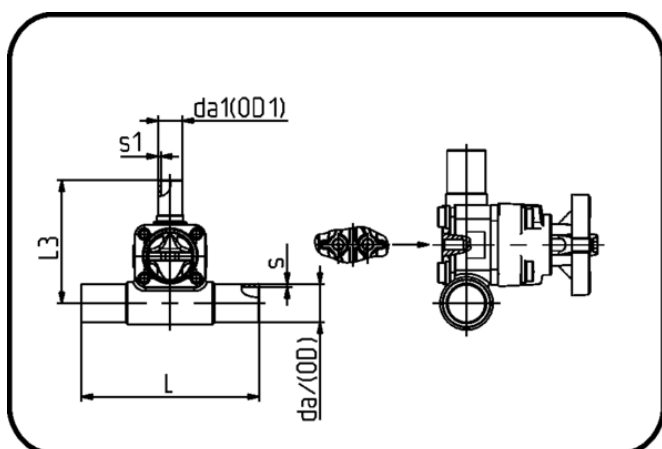

Code: 16.343

- T-Diaphragm Valve
- manually controlled
- EPDM/PTFE diaphragm
- Butt + IR-welding
- PP natural

Dimension	Code	Detail	da(OD) mm	da1(OD 1) mm	s mm	L mm	L3 mm	s1 mm	Weight
20/20	16.343.2021.11	20/20 - SDR11 MOP 10 bar	20	20	1,9	164	112	1,9	0.461
25/20	16.343.2521.11	25/20 - SDR11 MOP 10 bar	25	20	2,3	164	115,5	1,9	0.486
25/25	16.343.2526.11	25/25 - SDR11 MOP 10 bar	25	25	2,3	164	115,5	2,3	0.489
32/20	16.343.3221.11	32/20 - SDR11 MOP 10 bar	32	20	2,9	164	122	1,9	0.66
32/25	16.343.3226.11	32/25 - SDR11 MOP 10 bar	32	25	2,9	164	122	2,3	0.671
32/32	16.343.3233.11	32/32 - SDR11 MOP 10 bar	32	32	2,9	164	122	2,9	0.678
40/20	16.343.4021.11	40/20 - SDR11 MOP 10 bar	40	20	3,7	184	127	1,9	0.722
40/25	16.343.4026.11	40/25 - SDR11 MOP 10 bar	40	25	3,7	184	127	2,3	0.716
40/32	16.343.4033.11	40/32 - SDR11 MOP 10 bar	40	32	3,7	184	127	2,9	0.71
50/20	16.343.5021.11	50/20 - SDR11 MOP 10 bar	50	20	4,6	184	131,5	1,9	0.777
50/32	16.343.5033.11	50/32 - SDR11 MOP 10 bar	50	32	4,6	184	131,5	2,9	0.78
63/32	16.343.6333.11	63/32 - SDR11 MOP 10 bar	63	32	5,8	184	138	2,9	0.857