

PVCC Plain Fittings Inch Sizes Elbow 90°

Socket x Socket

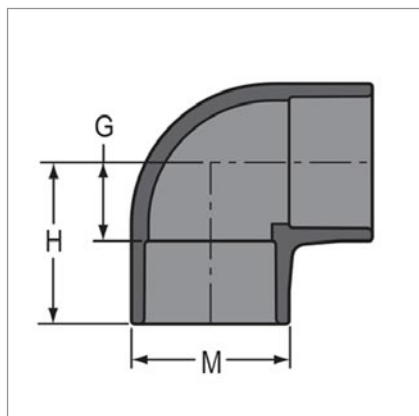

Size	Code	G	H	M	Approx Wt. (grams)
1/4	806-002C	8.73	25.40	20.64	13.50
3/8	806-003C	11.90	31.75	24.60	22.50
1/2	806-005C	14.29	37.30	30.16	36.00
3/4	806-007C	15.88	42.86	36.51	54.00
1	806-010C	22.23	50.80	44.45	90.00
1 1/4	806-012C	26.19	57.94	53.98	135.00
1 1/2	806-015C	29.37	59.69	60.33	175.50
2	806-020C	35.72	74.61	73.03	270.00
2 1/2	806-025C	39.69	84.93	88.10	490.50
3	806-030C	52.39	100.80	106.36	720.00
4	806-040C	66.68	123.83	132.55	1,251.00
6	806-060C	95.25	171.45	192.88	3,361.50
8	806-080C	121.44	223.04	247.65	6,435.00
10	806-100C*	146.84	274.64	308.77	11,853.00
12	806-120C*	173.83	327.82	365.13	19,827.00
14	806-140CF*	190.50	368.30	398.46	23,872.50
16	806-160CF*	395.29	598.49	449.26	45,769.50

* Max pressure rating 10bar at 20°C

Please note: This information is based on current manufacturers details, and is subject to change without notification.