

# Easy to install, flexible use

*The new Minilift S and Aqualift S Compact lifting stations*



# The space-saving lifting station



## Lifting station *Minilift S*

A washing machine, shower and sink can all be connected to the powerful *Minilift S* lifting station at the same time. The inconspicuous mono system is installed in the concrete floor slab to save space. The integrated drain in the cover handles basement surface water. Even in the event of a pipe burst or flooding, the *Minilift S* pumps away the wastewater keeping the basement rooms dry. The *Minilift S* is delivered ready to plug in with a 300 watt pump with float switch control.



## *Minilift S* Advantages at a glance

### Covers with integrated drain

Black or tileable, odour trap optional.

### Lock&Lift locking system

### Upper section

Vertically adjustable and rotatable.

### One-hand quick release

One-hand quick release of pump, tool free replacement of flap.

### Pre-installed inlets

Tool free connection of inlets.  
Suitable for different pipe materials.

### Fasteners

For securing to sub floor  
during concrete pour.

Click

### Pressure pipe set

Connected with only one "click".  
Including 5 m pressure hose  
Ø 40 (DN 32)

### Compact system

Ideal for renovation.



Quiet operation



Plug-in ready

### Warning control unit available as accessory

Article #

With electrode sensor  
With optical probe

20 222  
20 223

Outer diameter	Article #
Ø 40 mm	28 040

**Minilift S** lifting station  
for concrete floor slab installation



**Material:** Bottom section made of polymer

- Resistant to aggressive wastewater

**Version:**

- Mono system with float switch
- Removable pump, type KTP 300
- Connection for inlet Ø 50 mm and conduit pipe
- Pumping volume 7 l  
Pumping capacity max. 8 m³/h  
Pumping height max. 6 m
- Vertically adjustable upper section with integrated drainage function and flange for connection to waterproofing layer
- Backflow preventer for the pressure pipe
- Pump with multi-vane impeller
- System ready to plug in

**Cover:**

Tileable or black, Class K 3

**Cable length:** 5 m

**Installation depth (D):** 330 – 460 mm

**Cutout dimensions:** 600 × 600 mm

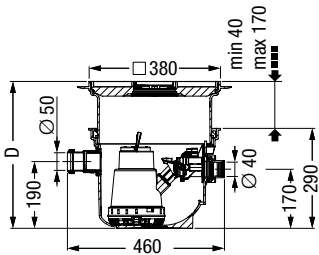

KTP pump	Voltage	Article #
tileable cover		
300-S1	230 V	280 570X
black cover		
300-S1	230 V	280 570S

**Pump capacity**

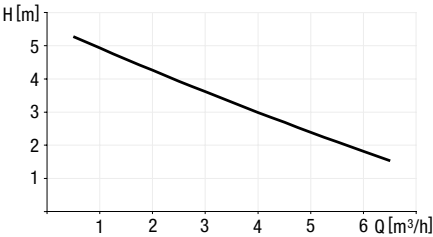

CE EN 12050-2

Always the right choice: ☒ ☐  
[smartselect.kessel.com](http://smartselect.kessel.com) ☒ ☐

# The powerful lifting station

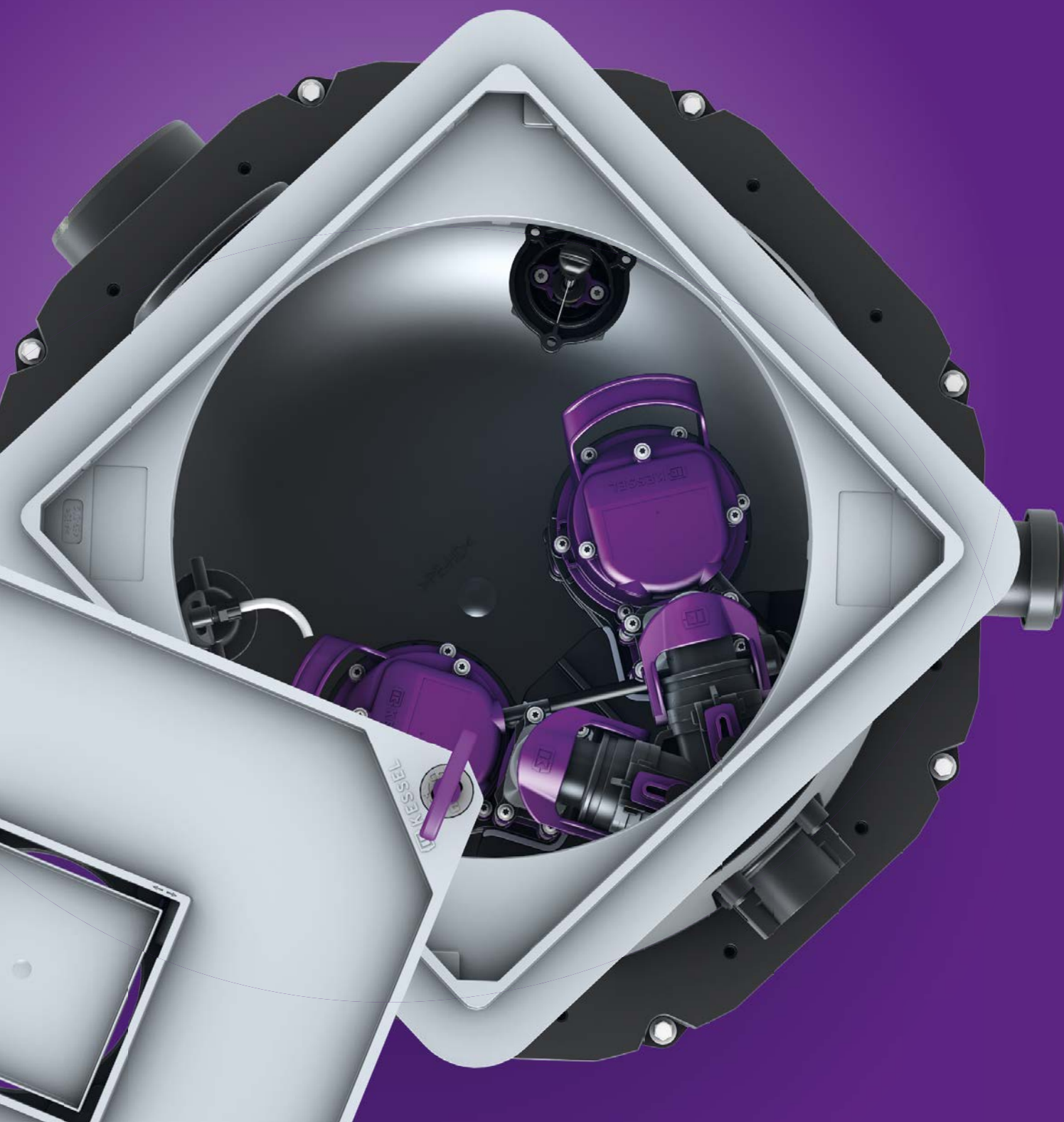

## Lifting station *Aqualift S Compact*

The *Aqualift S Compact* is a space-saving modifiable lifting station, which can easily be upgraded to a twin pump system at a later date. Installed in the concrete floor slab, the lifting station is almost invisible. The integrated drain cover handles surface wastewater. Even in the event of a pipe burst or flooding, the pump discharges the wastewater keeping the basement dry. The gasketed suspended pumps offer particularly quiet operation. The *Aqualift S Compact* is delivered from the factory with an optional one or two pumps which, depending on the requirements, are available with two performance levels with float or pressure control.



## *Aqualift S Compact* Advantages at a glance

### Safe with Tronic

Pressure sensor controlled.

### Covers with integrated drain

Black or tileable, odour trap optional.

### Upper section

Vertically adjustable and rotatable.

### Powerful

Pumps with 0.5 KW or 1.2 KW.  
*GTF 500 resistant* pump resistant to saline media, wastewater from softening units as well as wastewater containing condensate from heating systems.

### Variable

Mono-system with one pump or duo-system with two pumps.  
Mono-systems can be retrofitted into duo-systems, even after installation.

### Fasteners

For securing to sub floor during concrete pour.

### Sound-vibration reduction

With gasket suspended pump.

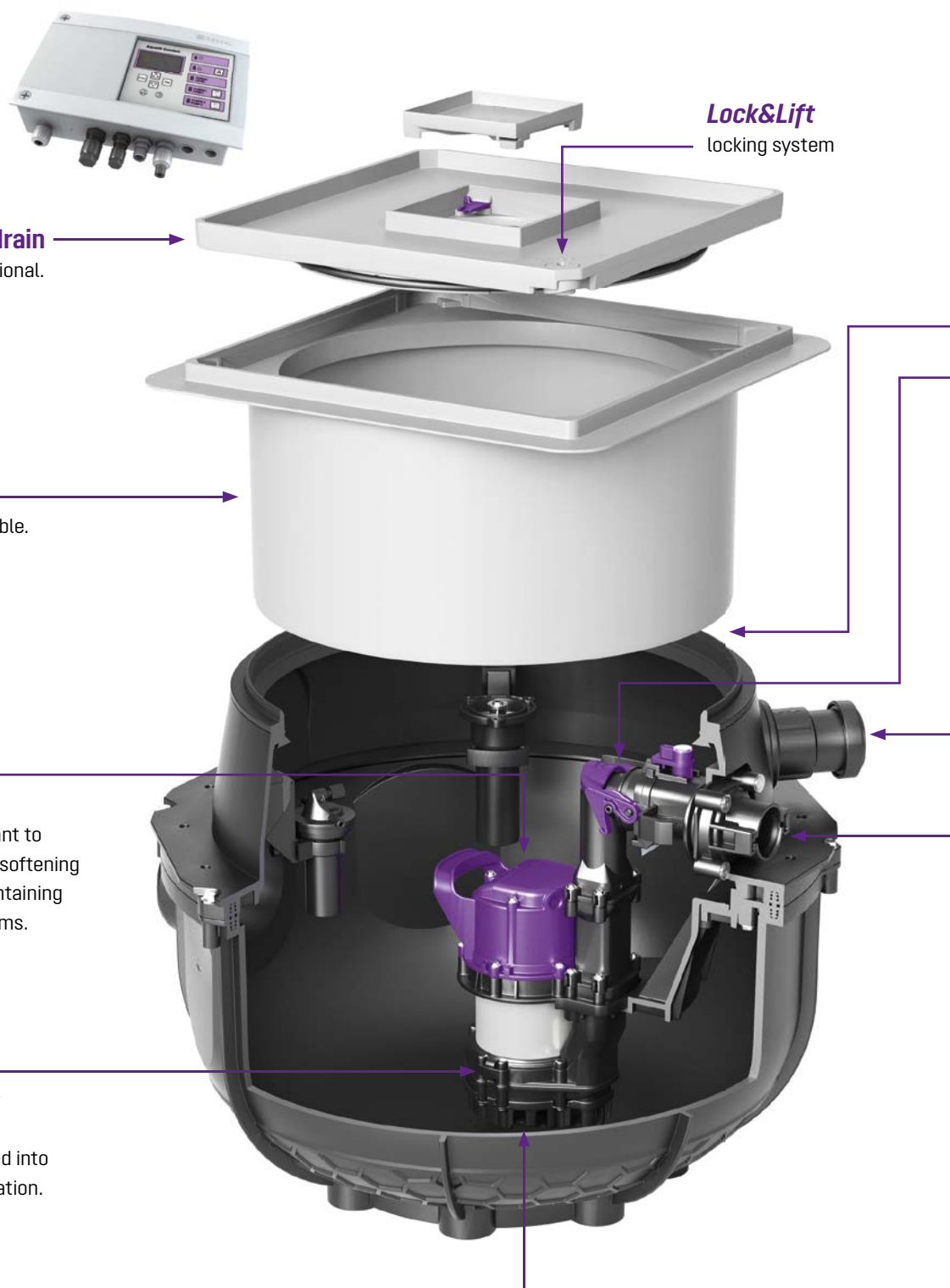

### Extension section with central flange

For installation in waterproof concrete.

#### Including sealing kit:

Counter flange made of polymer, screwed, elastomeric waterproof membrane.



Extension	Article #
max. 360 mm	83 075

### One-hand quick release

One-hand quick release of pump, tool free replacement of flap.



### Inlets

Tool free connection.

### Groundwater resistant

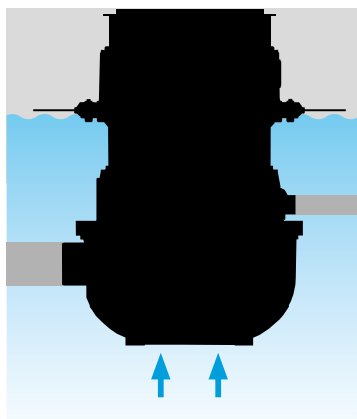

Click



### Pressure pipe set

Connected with only one "click".

Including 5 m pressure hose



Outer diameter	Article #
Ø 40 mm	28 040
Ø 50 mm	28 062*

\*available from 05/2019

**Aqualift S Compact Mono** lifting station

for underground installation

**Material:** polymer**Version:**

- One pump, type GTF, removable
- Float switch
- System ready to plug in
- Sockets for inlet and cable conduit
- Vertically adjustable upper section with integrated drainage function and flange for connection to waterproofing layer

**GTF 500 pump:**

Pumping volume 16 l

Pumping capacity max. 10 m<sup>3</sup>/h

Pumping height max. 8 m

**GTF 1200 pump:**

Pumping volume 20 l

Pumping capacity max. 15.5 m<sup>3</sup>/h

Pumping height max. 9 m

**GTF 500 resistant pump:**

Resistant to saline media,  
wastewater from softening units  
as well as wastewater containing  
condensate from heating systems

**Cover:**

Tileable or black, Class K 3

**Cable length:** 5 m**Installation depth (D):** 490 – 620 mm**Required installation dimensions:**

700 × 700 mm

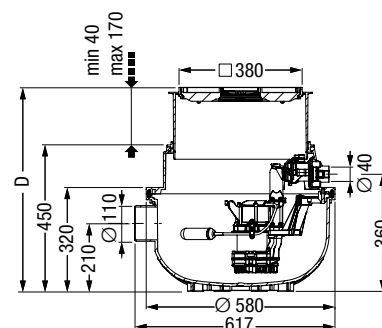
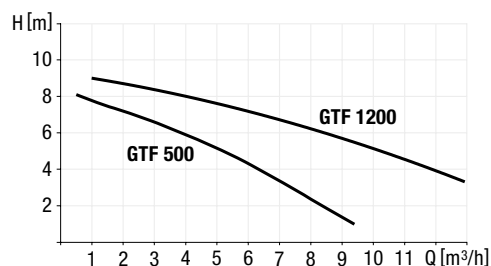
**Note:** available from 05/2019**Pump capacity**

GTF pump	Voltage	Article #
tileable cover		
500-S1	230 V	280 500X
500-S1 resistant	230 V	280 500XC
1200-S3	230 V	281 200X
black cover		
500-S1	230 V	280 500S
500-S1 resistant	230 V	280 500SC
1200-S3	230 V	281 200S

## Aqualift S Compact Mono/Duo Tronic lifting station

for underground installation



**Material:** polymer

**Version:**

- One or two pumps, type GTF, with pressure level measurement, removable
- Comfort control unit, display, USB interface and SDS self-diagnosis system
- Plug-in ready
- Sockets for inlet and conduit pipe
- Vertically adjustable upper section with integrated drainage function and flange for connection to waterproofing layer

**GTF 500 pump:**

Pumping volume 20 l

Pumping capacity max. 10 m<sup>3</sup>/h

Pumping height max. 8 m

**GTF 1200 pump:**

Pumping volume 20 l

Pumping capacity max. 15.5 m<sup>3</sup>/h

Pumping height max. 9 m

**GTF 500 resistant pump:**

Resistant to saline media, Wastewater from softening units as well as wastewater containing condensate from heating systems

**Cover:**

Tileable or black, Class K 3

**Cable length:** 5 m

**Installation depth (D):** 490 – 620 mm

**Cutout dimensions:** 700 × 700 mm

**Note:** available from 05/2019

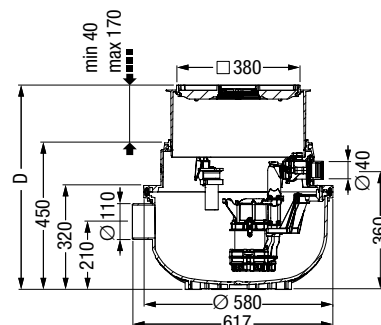
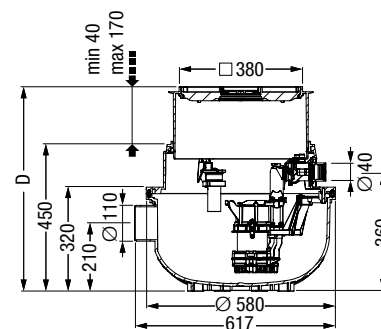

GTF pump	Voltage	Article #
----------	---------	-----------

### Mono system with one pump

#### tileable cover

500-S1	230 V	<b>280 550X</b>
500-S1 resistant	230 V	<b>280 550XC</b>
1200-S3	230 V	<b>281 250X</b>

#### black cover

500-S1	230 V	<b>280 550S</b>
500-S1 resistant	230 V	<b>280 550SC</b>
1200-S3	230 V	<b>281 250S</b>

### Duo system with two pumps

#### tileable cover

500-S1	230 V	<b>280 530X</b>
500-S1 resistant	230 V	<b>280 530XC</b>
1200-S3	230 V	<b>281 230X</b>

#### black cover

500-S1	230 V	<b>280 530S</b>
500-S1 resistant	230 V	<b>280 530SC</b>
1200-S3	230 V	<b>281 230S</b>

## Pump capacity

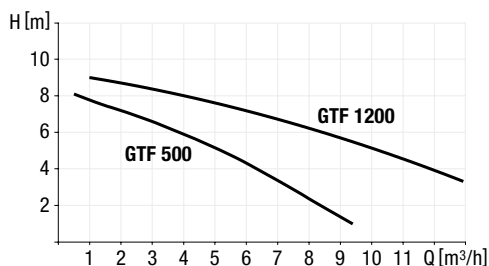



For further information visit

**[www.kessel.com](http://www.kessel.com)**



Subject to technical modifications.

**KESSEL AG**

Bahnhofstraße 31 • 85101 Lenting, Germany

[www.kessel.com](http://www.kessel.com)

016-107 P24/AM 03/19